

\$DATE\$
 \$TIME\$
 \$SCALE\$
 \$PENTBL\$

MATCHLINE B
 SEE SHEET L2

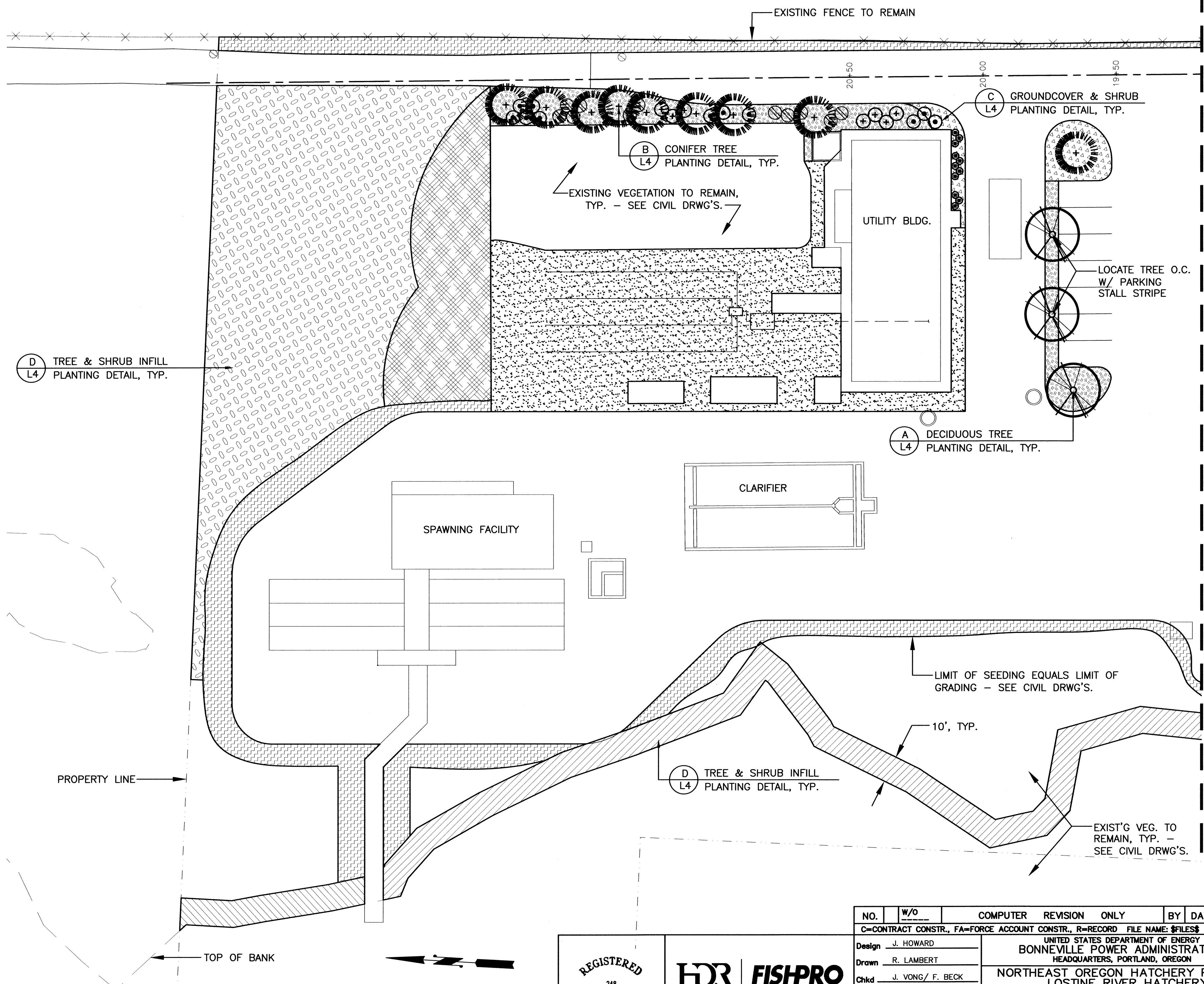

MATCHLINE A - SEE SHEET L2

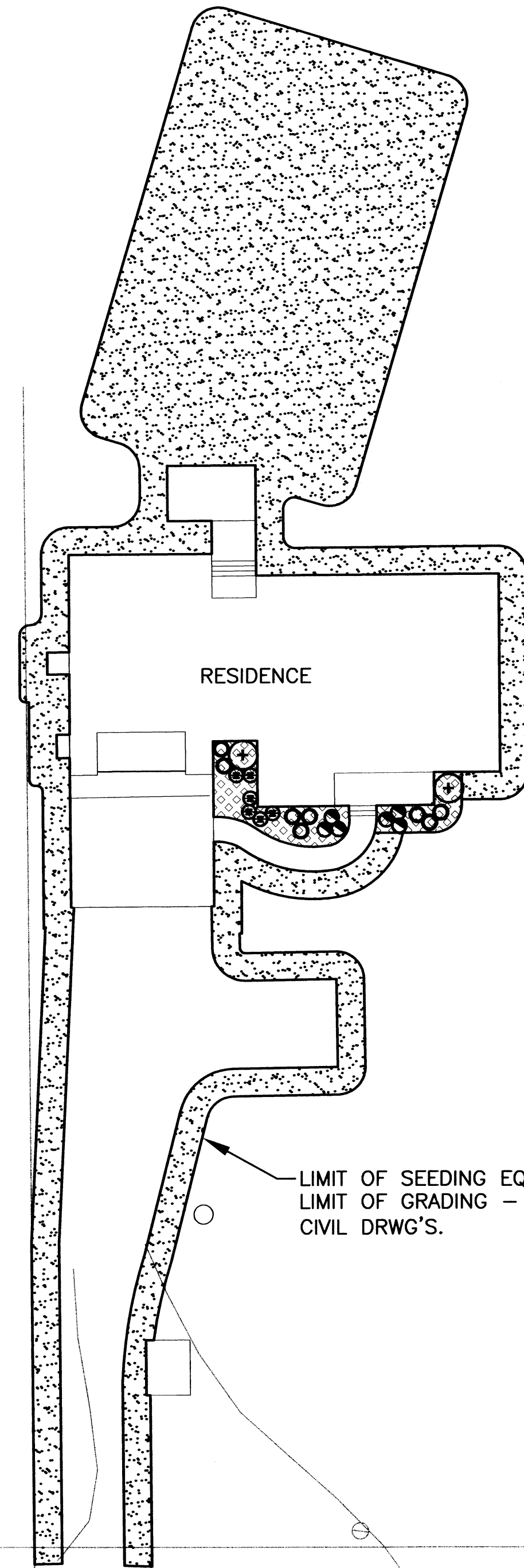
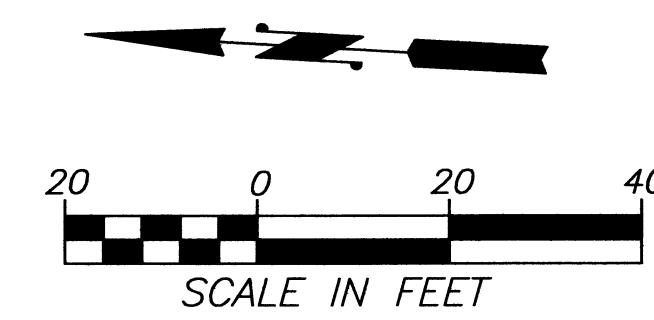

REGISTERED
 248
 Cole R. Hough-Beck
 OREGON
 LANDSCAPE ARCHITECT
 Engineer Seal

HDR | FISHPRO
HOUGH BECK & BAIRD INC.
 LANDSCAPE ARCHITECTURE PLANNING
 & URBAN DESIGN
 215 WESTLAKE AVENUE NORTH
 SEATTLE, WASHINGTON 98109
 (206) 682-3051

NO.	W/O	COMPUTER	REVISION	ONLY	BY	DATE	APPROVED
C=CONTRACT CONSTR., FA=FORCE ACCOUNT CONSTR., R=RECORD FILE NAME: \$FILES\$							
Design	J. HOWARD	UNITED STATES DEPARTMENT OF ENERGY BONNEVILLE POWER ADMINISTRATION HEADQUARTERS, PORTLAND, OREGON NORTHEAST OREGON HATCHERY PROGRAM LOSTINE RIVER HATCHERY HATCHERY PLANTING PLAN NORTH					
Drawn	R. LAMBERT						
Chkd	J. VONG / F. BECK						
Sub							
Rec							
Rec		SERIAL	SOURCE	SHEET NO.	SHEET	OF	REVISION
Appr				L1			
Date	4/10/06						

MATCHLINE A - SEE SHEET L1

MATCHLINE B
SEE SHEET L1

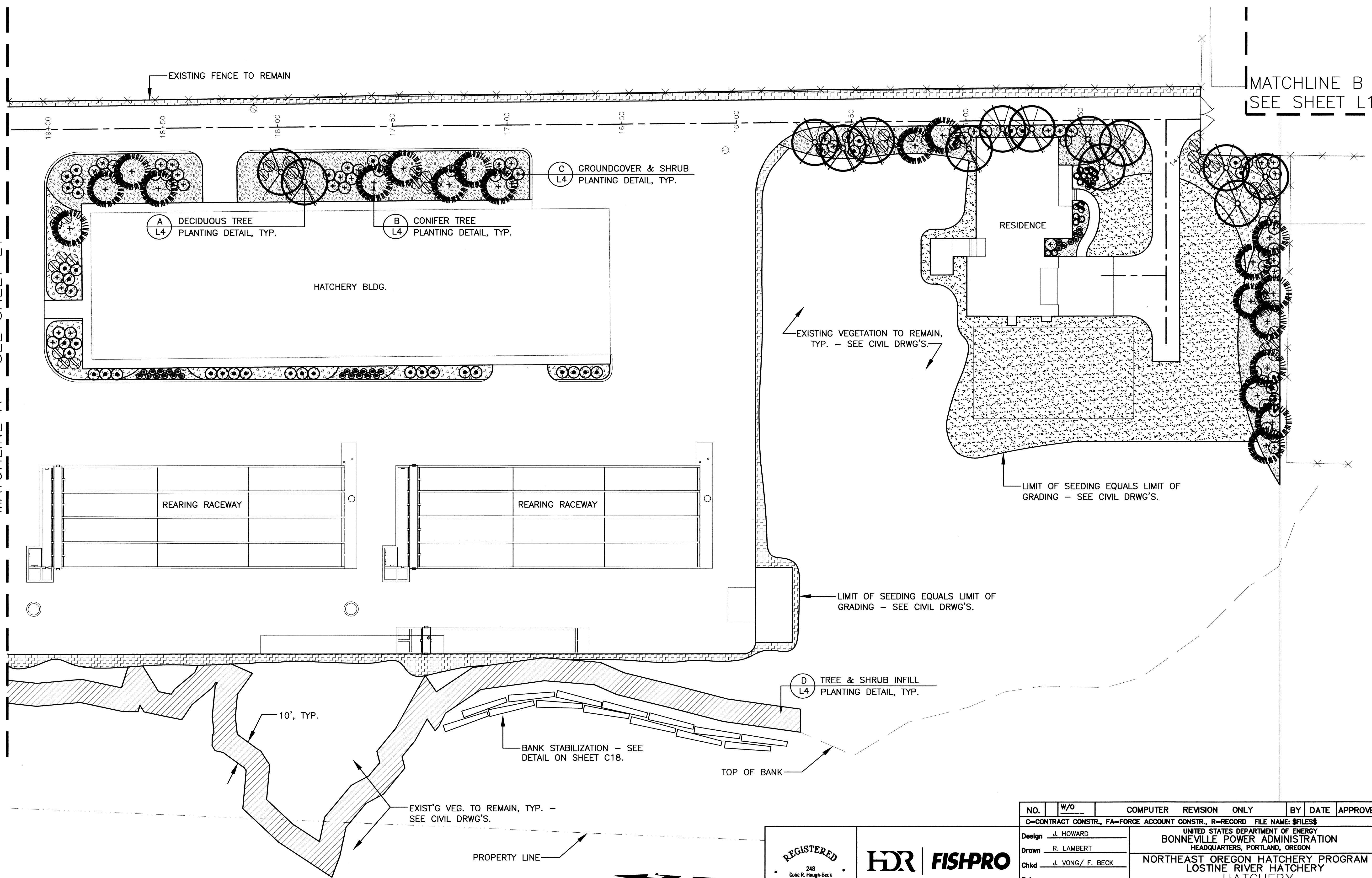

DATE\$
TIME\$
SCALE\$
PENTBL\$

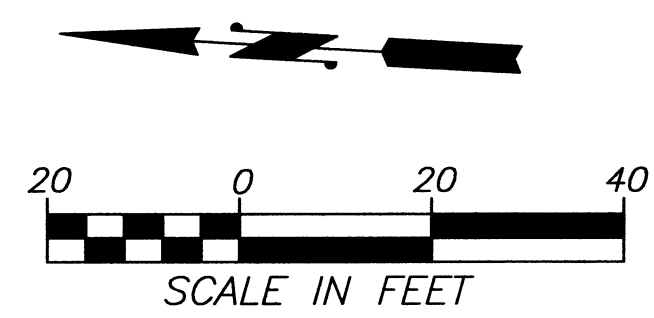

REGISTERED
248
Cole R. Hough-Beck
OREGON
LANDSCAPE ARCHITECT
Engineer Seal

HDR | FISHPRO

HOUGH BECK & BAIRD INC.
LANDSCAPE ARCHITECTURE PLANNING
& URBAN DESIGN
215 WESTLAKE AVENUE NORTH
SEATTLE, WASHINGTON 98109
(206) 882-3051

NO.	w/o	COMPUTER	REVISION	ONLY	BY	DATE	APPROVED
C=CONTRACT CONSTR., FA=FORCE ACCOUNT CONSTR., R=RECORD FILE NAME: \$FILES\$							
Design	J. HOWARD	UNITED STATES DEPARTMENT OF ENERGY BONNEVILLE POWER ADMINISTRATION HEADQUARTERS, PORTLAND, OREGON					
Drawn	R. LAMBERT	NORTHEAST OREGON HATCHERY PROGRAM LOSTINE RIVER HATCHERY HATCHERY					
Chkd	J. VONG / F. BECK	PLANTING PLAN SOUTH					
Sub		SERIAL					
Rec		SOURCE					
Rec		SHEET NO. SHEET					
Appr		L2 OF					
Date	4/10/06	REVISION					

PLANTING SCHEDULE

PLANTING NOTES

SYM. QTY. SCIENTIFIC/Common Name SIZE/REMARKS

TREES

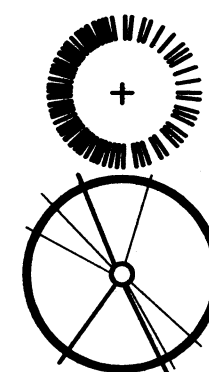

- 29 Pinus ponderosa/
PONDEROSA PINE 6'-7' Ht.; B&B/Cont.; Straight trunk not sheared. Symmetrical Full & well branched.
- 17 Populus tremuloides/
QUAKING ASPEN 2" Cal; B&B; Full, well branched & well rooted. Straight central leader & single trunk. Symmetrical branching habit. Min. 6' branching ht. within parking lot areas.

SHRUBS

- 67 Symphoricarpos albus/
COMMON SNOWBERRY 5 Gal. Cont.; Full, well branched & well rooted.
- 64 Amelanchier alnifolia/
WESTERN SASKATOON SERVICEBERRY 5 Gal. Cont.; Full, well branched & well rooted.
- 55 Holodiscus discolor/
OCEAN SPRAY 5 Gal. Cont.; Full, well branched & well rooted.
- 17 Viburnum opulus 'nana'/
DWARF EUROPEAN CRANBERRYBUSH 5 Gal. Cont.; Full, well branched & well rooted.
- 49 Potentilla 'Abbotswood'/
ABBOTSWOOD POTENTILLA 5 Gal. Cont.; Full, well branched & well rooted.
- 14 Potentilla 'Abbotswood'/
BLUE OAT GRASS 5 Gal. Cont.; Full, well branched & well rooted.

GROUNDCOVERS

- 2,196 Arcostaphylos uva-ursi/
KINNIKINNICK 1 Gal. Cont.; Full, well branched & well rooted. Triangular Spacing @ 18" O.C.
- 323 Fragaria vesca/
WILD STRAWBERRY 1 Gal. Cont.; Full, well branched & well rooted. Triangular Spacing @ 18" O.C.
- 406 Sedum X 'Autumn Joy'/
AUTUMN JOY SEDUM 1 Gal. Cont.; Full, well branched & well rooted. Triangular Spacing @ 15" O.C.
- * MULCH TOPDRESSING See spec's - 2" depth mulch and 12" depth planting soil.

WETLAND MITIGATION TREE & SHRUB MIX

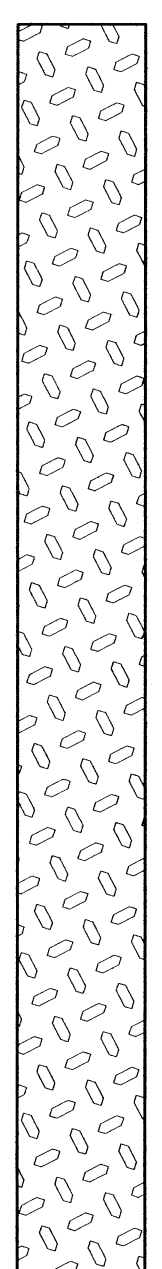

- TREES:
- 20 Picea engelmannii/
ENGLEMAN SPRUCE 3 Gal. Cont.; Full, well branched & well rooted. Triangular Spacing @ 20' O.C.
 - 30 Thuja plicata/
WESTERN RED CEDAR 3 Gal. Cont.; Full, well branched & well rooted. Triangular Spacing @ 20' O.C.
- SHRUBS:
- 10 Cornus sericea/
REDTWIG DOGWOOD 1 Gal. Cont.; Full, well branched & well rooted. Triangular Spacing @ 15' O.C.
 - 5 Ribes divaricatum/
COAST BLACK CURRANT 1 Gal. Cont.; Full, well branched & well rooted. Triangular Spacing @ 15' O.C.
 - 10 Rubus spectabilis/
SALMONBERRY 1 Gal. Cont.; Full, well branched & well rooted. Triangular Spacing @ 15' O.C.

WITHIN THE WETLAND MITIGATION TREE & SHRUB PLANTING AREA, NEW TREES & SHRUBS SHALL BE PLANTED AS INFILL PLANTINGS BETWEEN EXISTING TREE & SHRUBS TO REMAIN. AFTER PLANTING, THE MIN. DENSITY OF TREE COVERAGE ACROSS THE AREA (INCLUDING NEW & EXISTING TREES) SHALL BE 20' ON CENTER. THE MIN. DENSITY OF SHRUB COVERAGE ACROSS THE AREA (INCLUDING NEW & EXISTING SHRUBS) SHALL BE 15' ON CENTER. LOCATIONS OF INDIVIDUAL PLANT VARIETIES WITHIN THE LAYOUT DESCRIBED ABOVE SHALL BE RANDOM. PLANT LAYOUT SHALL BE FIELD STAKED & APPROVED BY THE WETLAND BIOLOGIST PRIOR TO INSTALLATION.

SYM. QTY. SCIENTIFIC/Common Name SIZE/REMARKS

TOP OF BANK SLOPE PROTECTION MIX

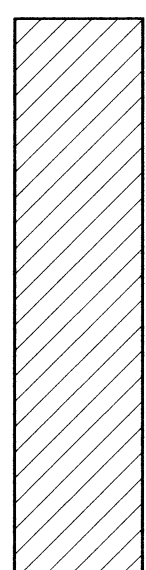

- * Cornus sericea/
REDTWIG DOGWOOD (25%) 1 Gal. Cont.; Full, well branched & well rooted. Triangular Spacing @ 6" O.C.
- * Symphoricarpos albus/
COMMON SNOWBERRY (25%) WITHIN THE TOP OF BANK SLOPE PROTECTION PLANTING AREA, NEW SHRUBS SHALL BE PLANTED AS INFILL PLANTINGS BETWEEN EXISTING TREE & SHRUBS TO REMAIN. THE MIN. DENSITY OF SHRUB COVERAGE ACROSS THE AREA (INCLUDING NEW & EXISTING SHRUBS) SHALL BE 6' ON CENTER. LOCATIONS OF INDIVIDUAL PLANT VARIETIES WITHIN THE LAYOUT DESCRIBED ABOVE SHALL BE RANDOM. PLANT LAYOUT SHALL BE FIELD STAKED & APPROVED BY THE WETLAND BIOLOGIST PRIOR TO INSTALLATION.
- * Holodiscus discolor/
OCEAN SPRAY (25%)
- * Philadelphus lewisii/
MOCK ORANGE (25%)

* WHERE QUANTITIES ARE NOT GIVEN IN THE PLANTING SCHEDULE, THE CONTRACTOR SHALL BE RESPONSIBLE FOR DETERMINING MULCH, SOIL & PLANT QUANTITIES TO BE USED. PERCENTAGES USED INDICATE PERCENTAGE OF TOTAL PLANTING AREA TO RECEIVE PLANT MATERIALS.

SEED MIXES



QTY. S.F.	LAWN SEED	VARIETY OF SEED IN MIXTURE	PERCENT BY WEIGHT	MINIMUM PERCENT PURE SEED	MINIMUM PERCENT GERMINATION
24,556		BARLEXAS II TALL FESCUE	33.3%	98%	90%
		BARRERA TALL FESCUE	33.3%	98%	90%
		TRACER TALL FESCUE	33.3%	98%	90%
TOTAL			100% OF TOTAL SEED MIX		
Percent Weed Seed			0.5% Maximum		
Inert & Other Crop			1.5% Maximum		

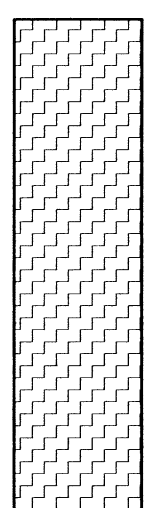

QTY. S.F.	EROSION CONTROL SEED	VARIETY OF SEED IN MIXTURE	PERCENT BY WEIGHT	MINIMUM PERCENT PURE SEED	MINIMUM PERCENT GERMINATION
10,438		BARGENA CREEPING RED FESCUE	49%	98%	90%
		HARDTOP HARD FESCUE	17%	98%	90%
		BAROK SHEEP FESCUE	15%	98%	90%
		BARON KENTUCKY BLUE GRASS	14%	98%	90%
		ALICE COATED WHITE CLOVER	5%	98%	90%
TOTAL			100% OF TOTAL SEED MIX		
Percent Weed Seed			0.5% Maximum		
Inert & Other Crop			1.5% Maximum		

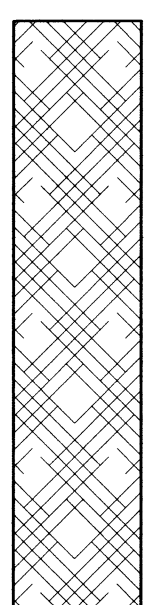

QTY. S.F.	BIO-SWALE SEED	VARIETY OF SEED IN MIXTURE	PERCENT BY WEIGHT	MINIMUM PERCENT PURE SEED	MINIMUM PERCENT GERMINATION
3,302		BARGENA CREEPING RED FESCUE	49%	98%	90%
		HARDTOP HARD FESCUE	17%	98%	90%
		BAROK SHEEP FESCUE	15%	98%	90%
		PINNACLE PERENNIAL RYEGRASS	7%	98%	90%
		PREMIER PERENNIAL RYEGRASS	7%	98%	90%
		ALICE COATED WHITE CLOVER	5%	98%	90%
TOTAL			100% OF TOTAL SEED MIX		
Percent Weed Seed			0.5% Maximum		
Inert & Other Crop			1.5% Maximum		

- ANY DISCREPANCIES W/ THE DRWG'S AND/OR SPEC'S & SITE CONDITIONS SHALL BE BROUGHT TO THE ATTENTION OF L.A. PRIOR TO PROCEEDING W/ CONSTRUCTION.
- THE CONTRACTOR IS RESPONSIBLE FOR LOCATING UTILITIES PRIOR TO BEGINNING CONSTRUCTION.
- GROUNDCOVERS SHALL BE PLANTED IN A TRIANGULAR PATTERN AT SPACING SHOWN IN THE PLANT SCHEDULE. WHERE GROUNDCOVER ABUTS CURBING, WALLS OR WALKS, MIN. PLANTING DISTANCE SHALL BE NINE (9) INCHES FROM SAME.
- PLANTING DRAWING IS BASED UPON BASE DRAWINGS DATED 3/22/06. PREPARED BY: HDR/FISHPRO

ABBREVIATIONS

&	AND
# OR NO.	NUMBER
@	AT
%	PERCENT
B&B	BALLED AND BURLAPPED
BLDG.	BUILDING
CAL.	CALIPER
CONST.	CONSTRUCTION
CONT.	CONTAINER
DIA.	DIAMETER
DRWG'S.	DRAWINGS
EA.	EACH
EXIST'G	EXISTING
GAL.	GALLON
HT.	HEIGHT
L.A.	LANDSCAPE ARCHITECT
MAX.	MAXIMUM
MFR'S	MANUFACTURER'S
MIN.	MINIMUM
PT.	POINT
O.C.	ON CENTER
QTY.	QUANTITY
SCHED.	SCHEDULE
S.F.	SQUARE FEET
SPEC'S.	SPECIFICATIONS
STA.	STATION
SYM.	SYMBOL
TEL.	TELEPHONE
TYP.	TYPICAL
W/	WITH

LEGEND

(A)	DETAIL IDENTIFICATION
(L1)	SHEET IDENTIFICATION
---	PROPERTY LINE
---	STA.+PT. LINE

NO.	W/O	COMPUTER REVISION ONLY	BY	DATE	APPROVED
C=CONTRACT CONSTR., FA=FORCE ACCOUNT CONSTR., R=RECORD FILE NAME: \$FILES\$					
Design	J. HOWARD	UNITED STATES DEPARTMENT OF ENERGY BONNEVILLE POWER ADMINISTRATION HEADQUARTERS, PORTLAND, OREGON			
Drawn	R. LAMBERT	NORTHEAST OREGON HATCHERY PROGRAM LOSTINE RIVER HATCHERY HATCHERY			
Chkd	J. VONG/ F. BECK	PLANTING SCHEDULE, PLANTING NOTES, ABBREVIATIONS & LEGEND			
Sub		SERIAL	SOURCE	SHEET NO.	SHEET OF
Rec				L3	OF
Appr					
Date	4/10/06				

REGISTERED
248
Celine R. Hough-Beck
OREGON
LANDSCAPE ARCHITECT
Engineer Seal

HDR | FISHPRO

HOUGH BECK & BAIRD INC.
LANDSCAPE ARCHITECTURE PLANNING
& URBAN DESIGN
215 WESTLAKE AVENUE NORTH
SEATTLE, WASHINGTON 98109
(206) 682-3051

\$DATE\$
\$TIME\$
\$SCALE\$
\$PENIBLS\$

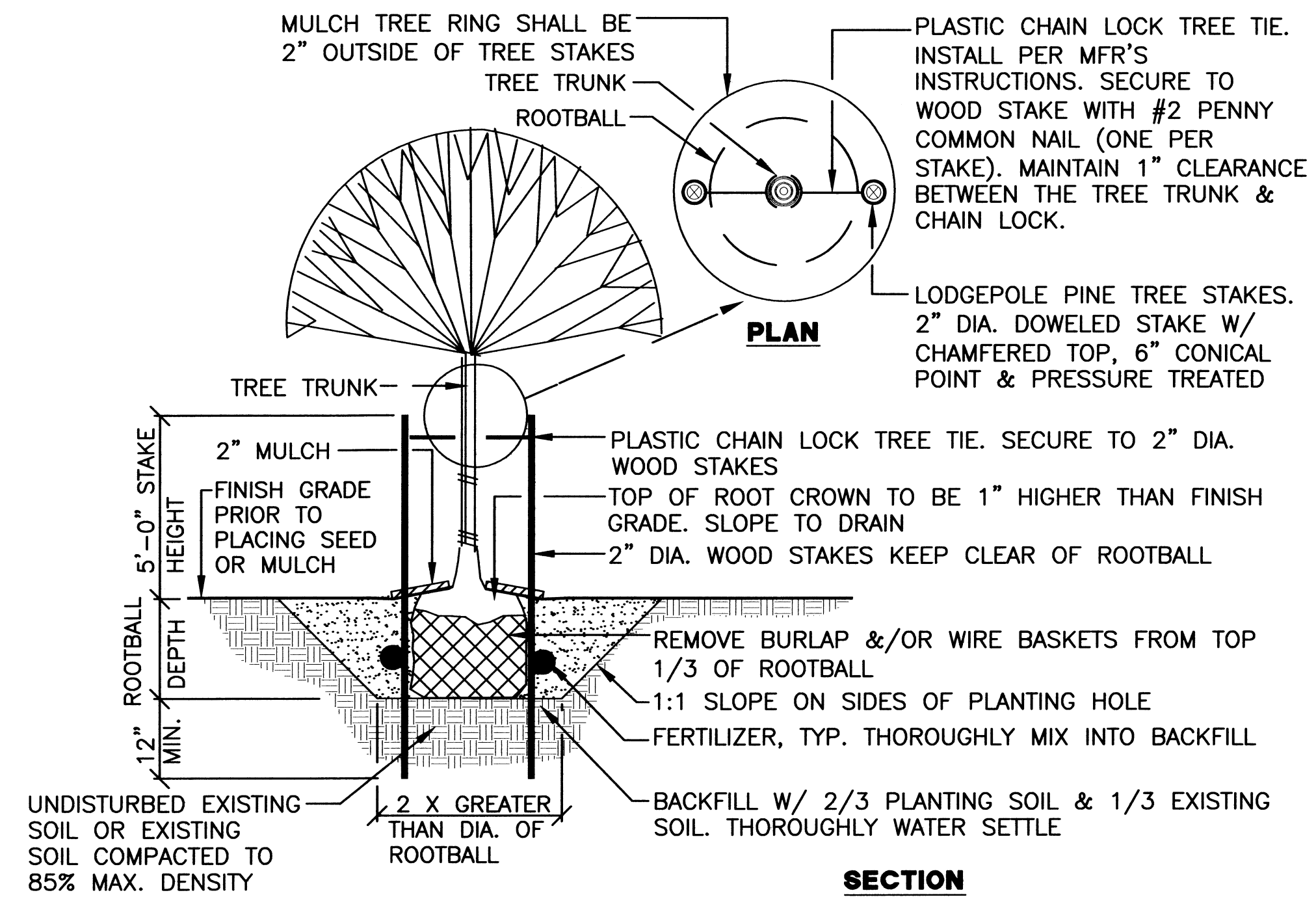

A DECIDUOUS TREE PLANTING DETAIL
NOT TO SCALE

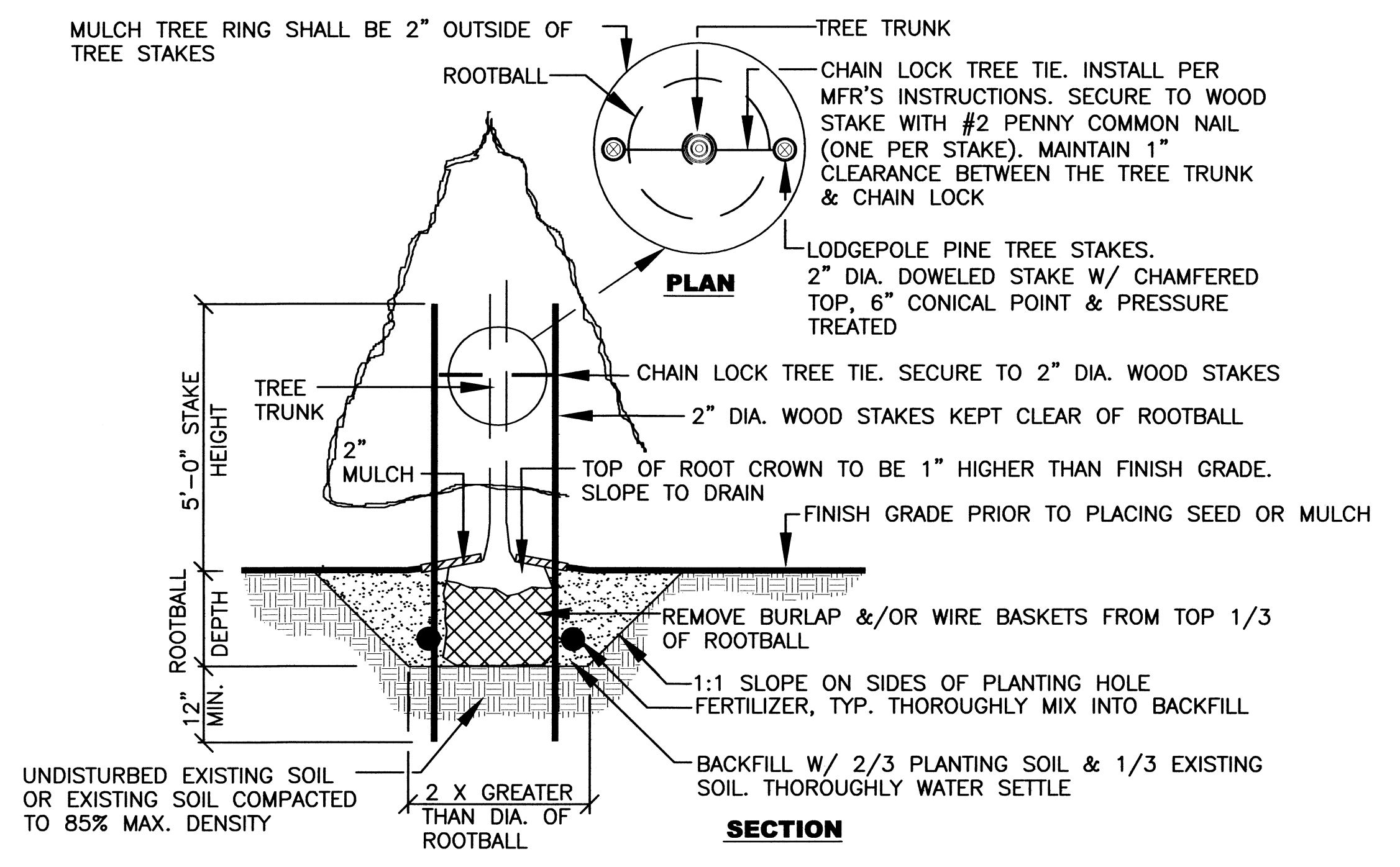

B CONIFER TREE PLANTING DETAIL
NOT TO SCALE

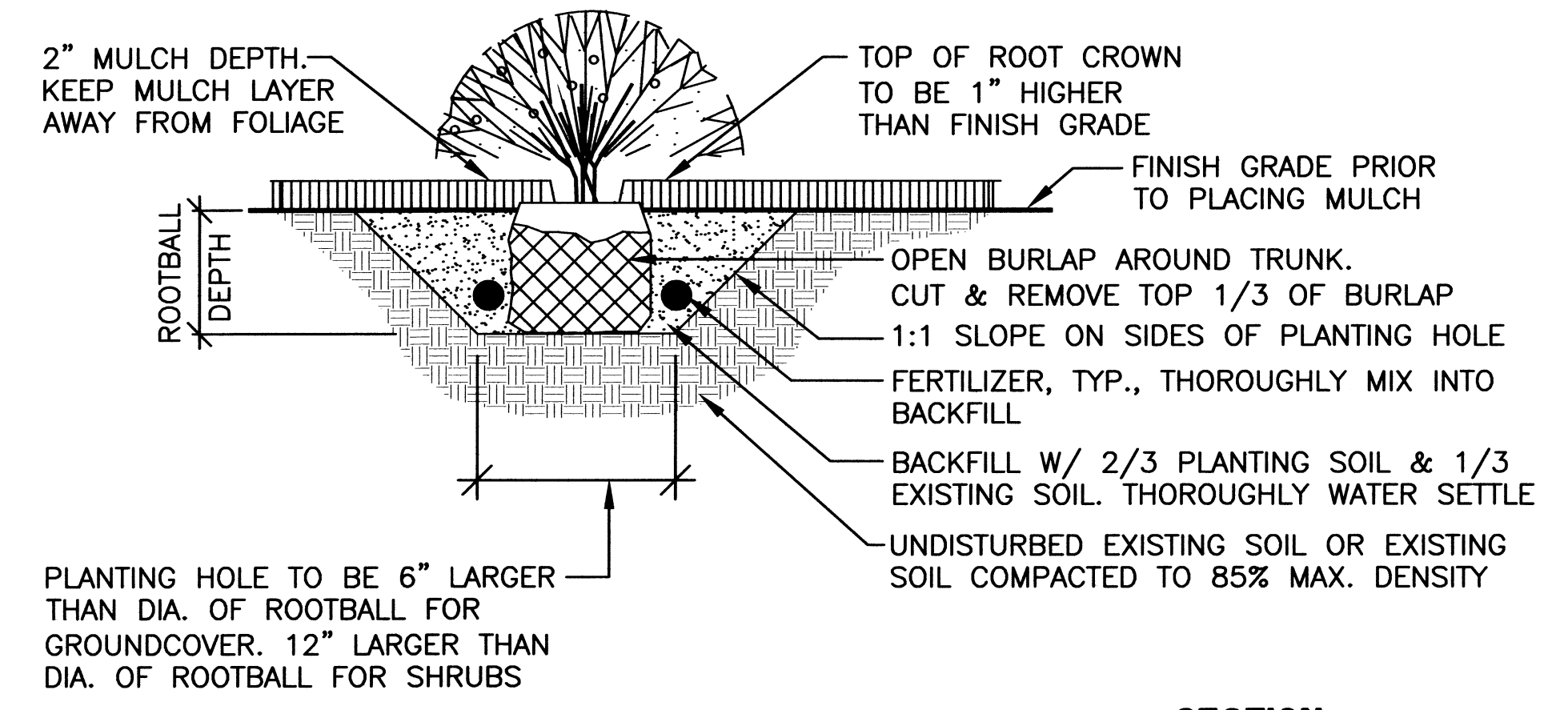

C GROUNDCOVER & SHRUB PLANTING DETAIL
NOT TO SCALE

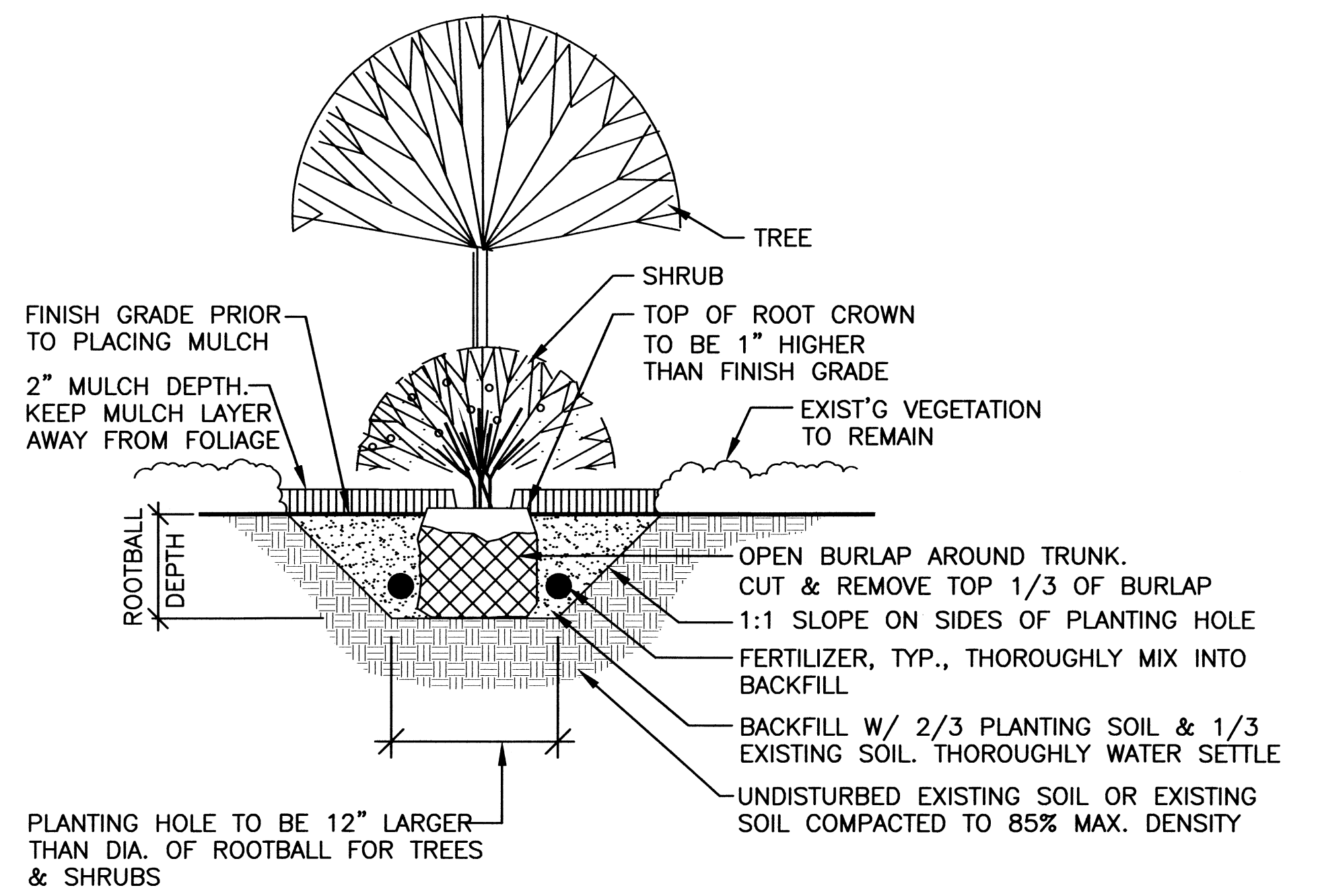

D TREE & SHRUB INFILL PLANTING DETAIL
NOT TO SCALE

DATE\$
TIME\$
SCALE\$
PENTBL\$

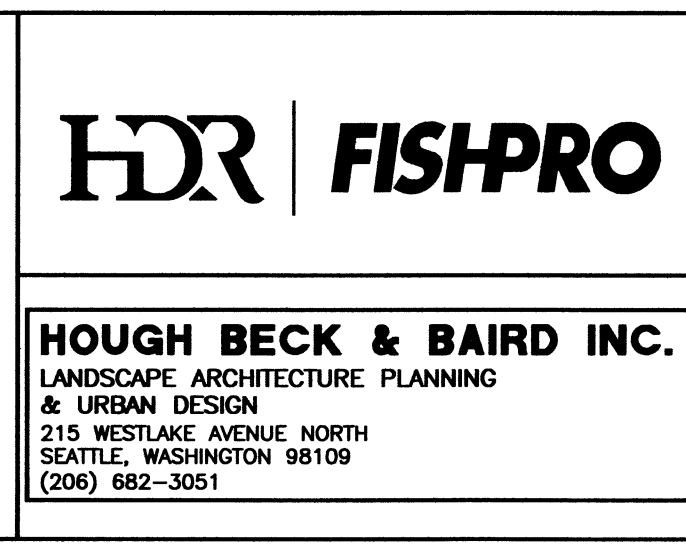
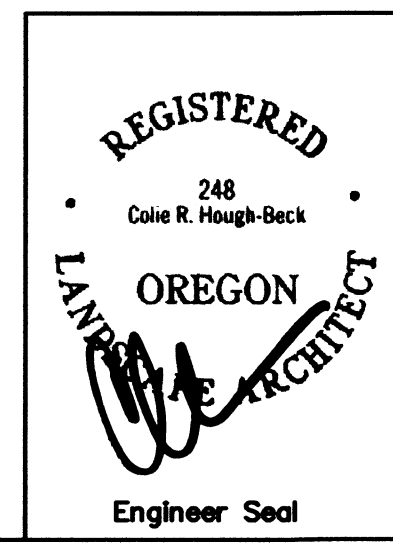

NO.	W/O	COMPUTER	REVISION	ONLY	BY	DATE	APPROVED
C=CONTRACT CONSTR., FA=FORCE ACCOUNT CONSTR., R=RECORD FILE NAME: \$FILES\$							
Design	J. HOWARD	UNITED STATES DEPARTMENT OF ENERGY BONNEVILLE POWER ADMINISTRATION HEADQUARTERS, PORTLAND, OREGON NORTHEAST OREGON HATCHERY PROGRAM LOSTINE RIVER HATCHERY HATCHERY PLANTING DETAILS					
Drawn	R. LAMBERT						
Chkd	J. VONG / F. BECK						
Sub							
Rec							
Appr		SERIAL	SOURCE	SHEET NO.	SHEET	REVISION	
Date	4/10/06			L4	OF		

PART 1 GENERAL

1.01 GENERAL

- A. Prior to final acceptance of the Landscaping, the Contractor shall submit a written "watering schedule" to the Owner to ensure adequate watering (summer, fall, winter & spring) of all plant materials during the Guarantee Period of this Contract.

1.02 REVIEW OF PLANT MATERIALS

- A. The review and approval of all plant materials by the Landscape Architect PRIOR TO PLANTING is mandatory.
- B. Owner reserves the right to reject, through his/her agent, any or all plant material at any time until final review and acceptance. Remove rejected plants immediately from site.

1.03 SUBMITTALS

- A. Plant Material Documentation:
 - Within fourteen (14) calendar days after award of a Contract, submit written documentation to the Landscape Architect that all specified plant materials have been ordered. Should the Contractor neglect to provide this documentation within the allocated time, Contractor may forfeit any substitution benefits.
- Soil Tests: 2.01 & 2.02
- Watering Schedule: See 1.01
- Seed Analysis: See Sheet L3

1.04 TEMPORARY STORAGE OF PLANT MATERIAL

- A. Plant at once all plant material delivered and accepted. Plants that cannot be planted within one (1) day after arrival to the project site shall be "heeled-in" in accordance with accepted horticultural practice and the following requirements:
 - Protect rootball of balled and burlapped plants with moist earth, sawdust or other acceptable material.
 - Protect plant materials at all times from extreme weather conditions and keep moist.

1.05 GUARANTEE / MAINTENANCE

- A. Guarantee work of this Specification section for one (1) year against all defects of materials and workmanship. The guarantee period begins after the date of final acceptance. Replace plants not in normal healthy growing condition at the end of guarantee period. Replace with plants with identical species and size. Final acceptance will be certified in writing by the Owner.
- B. It is expressly understood that the Contractor will be responsible, during the Guarantee Period, for normal landscape maintenance of the project. Maintenance of the landscape shall include, but not be limited to, watering, mowing, weeding, monitoring and treating any disease and/or pest-problems, cultivating and any other maintenance requirements (per standard trade practices) to keep the plant materials in a normal healthy growing condition.

PART 2 PRODUCTS

2.01 EXISTING SUBGRADE SOIL

- A. Soil tests of the subgrade soil shall be made by the Contractor to determine MECHANICAL ANALYSIS (per USDA Particle Size and Organic Matter Test) and FERTILITY ANALYSIS (to determine magnesium, nitrogen, potassium, and phosphorus levels; soluble salts/conductivity and pH). Contractor shall send a minimum of three (3) representative samples of subgrade soil to an approved soil testing laboratory (state laboratory or recognized commercial laboratory). The cost for testing must be borne by the Contractor. TEST RESULTS AND LABORATORY RECOMMENDATIONS FOR ORNAMENTAL PLANT GROWTH must be submitted to the Landscape Architect for approval prior to incorporating soil additives into the subgrade and placing planting soil.

2.02 PLANTING SOIL

- A. Planting Soil shall be Topsoil provided by Moffit Brothers Construction, Tel: (541) 569-2284 or approved equal.
- B. Contractor shall send minimum of one (1) representative sample of Planting Soil to an approved soil testing laboratory (state or commercial laboratory) to determine FERTILITY ANALYSIS (to determine magnesium, nitrogen, potassium, phosphorus levels, calcium, minor elements, soluble salts/conductivity and pH). The results shall be submitted to the Landscape Architect (WITH TEST RESULTS AND LABORATORY RECOMMENDATIONS FOR ORNAMENTAL PLANT GROWTH) for approval prior to use on the project site. The Contractor shall be responsible for whatever soil additives may be required, as recommended by the testing laboratory. The cost for testing and soil additions must be borne by the Contractor.
- C. Submit planting soil laboratory tests for Landscape Architect's review and approval prior to use on project site.

2.03 BARK MULCH

- A. Bark mulch shall be derived from Red Fir species. It shall be ground so that a minimum of 95 percent of the material will pass through a 1½-inch sieve and no more than 55 percent, by loose volume, will pass through a U.S. No. 4 sieve. The mulch shall not contain resin, tannin, or other compounds in quantities that would be detrimental to plant life. Bark mulch shall be supplied by Eastern Oregon Nursery & Landscape, Tel: (541) 432-8588 or approved equal.

2.04 FERTILIZER

- A. Commercial Fertilizer for seed lawn planting areas during planting shall be granular fertilizer containing the following percentages by weight:

10% Nitrogen (N)
20% Phosphorus (P)
20% Potash (K)

2.05 PLANTS

- A. Trees, Shrubs and Groundcover
 - All plants shall be nursery grown, or normal habit of growth, healthy, vigorous and free of disease, insect eggs and larvae. Grading of plant material and root ball/container sizes shall be in accordance with the code of standards of the American Association of Nurserymen. Nomenclature shall conform with Hortus Third, latest edition accepted nomenclature in the nursery trade.
 - Plants are required to be from stock acclimated to Project Site environmental conditions, having been consistently cultivated and grown under these conditions.

2.06 SEED

- A. General:
 - A complete analysis of each type of seed mix shall be submitted to the Landscape Architect, including percent of pure seed, germination, other crop seed, inert and weeds, and the germination test data. All crop seed in excess of one (1) percent must be itemized.
 - Seed supplied by Barenburg USA Production, Boardman, Oregon, Tel: (541) 806-7333.

PART 3 EXECUTION

3.01 GENERAL

- A. All areas shall be finish graded and approved by the Landscape Architect before commencement of planting. All areas shall allow for planting soil and mulch added to individual planting areas as specified herein. All grades shall flow smoothly into one another and produce positive drainage. The Contractor is responsible for any adverse drainage conditions that may affect plant growth unless the Contractor contacts the Landscape Architect immediately, indicating any possible problem. Verify all grades with Landscape Architect before commencement of planting.

3.02 SUBGRADE

- A. Rototill or scarify all compacted subgrade soils to a minimum depth of six (6) inches prior to placement of planting soil. If additional rototilling or scarifying, below six (6) inches, is required to eliminate surface water ponding, the Contractor shall notify Landscape Architect of problem areas.

3.03 SOIL PREPARATION

- A. All areas to receive tree, shrub, groundcover and seed planting shall be cleared of all debris before rototilling. Provide and install a min. six (6) inch depth of compacted planting soil over all seed planting areas and rototill to a depth of eight (8) inches into the subgrade. Provide and install a min. twelve (12) inch depth of planting soil over all tree, shrub, and groundcover planting areas (NOT TOP OF BANK SLOPE PROTECTION OR WETLAND MITIGATION TREE AND SHRUB AREAS). Drag to even grade, remove debris and rocks larger than one (1) inch in diameter, and then roll for firmness prior to planting.

B. Finish Grading

- Finish grade is defined as the top surface of planting soil prior to the installation of mulch, seed lawn, erosion control seed and bio-swale seed unless otherwise noted on the Drawings.
- Compact finish grade to eighty-five (85) percent of maximum dry density as determined by ASTM: D 1557.
- After settling, finish grades in seed planting areas shall be one half (1/2) inch below all walks, curbs and/or other hard surfaces.
- After settling, finish grades in tree, shrubs and groundcover planting areas shall be two (2) inches below all walks, curbs, and/or other hard surface edges.

3.04 STAKING AND LAYOUT

- A. Staking and layout refers to locating and verifying all planting locations. Make required field adjustments as directed without additional cost to the Owner. No work shall commence on installation of materials until staking and layout is verified by the Landscape Architect.
- B. Contractor shall notify Landscape Architect in writing immediately of any variance between plans and actual site conditions and await instructions before proceeding.

3.05 TREE, SHRUB AND GROUNDCOVER INSTALLATION

- A. Provide all planting areas with uniform two (2) inch layer of mulch material over a properly cleaned and graded surface unless otherwise noted on Drawings. However, before installing mulch, the Contractor shall contact the Landscape Architect for a semi-final inspection of planting area grades, soil depth and plant locations. Should the Contractor install mulch before inspection, it will be at the Contractor's own risk. Provide and install mulch rings around infill planting trees and shrubs as shown in "Tree & Shrub Infill Planting Detail".

3.06 SEED INSTALLATION

- A. General:
 - Seed shall be spread by approved mechanical (hopper or culti-packer) or hydro-seed/mulch methods only. Hydro-seeding shall include first application with seed and 10% mulch fiber; second application with no seed and 90% mulch fiber.
 - Seeding shall be done only after planting soil placement, finish grading and adjacent construction and plantings have been completed.
 - Mulch shall be SILVA MULCH or approved equal at forty-five (45) pounds per 1,000 square feet.
 - Binder shall be J-TAC or approved equal at two (2) pounds per 1,000 square feet.
- B. Any seeded areas that have become compacted prior to seeding must be scarified to a depth of six (6) inches by approved means, then finish graded as herein before described.
- C. Seeding
 - After finish grading of the Seed Lawn and Erosion Control Seed planting areas, the Contractor shall apply Fertilizer at the minimum rate of thirty (30) pounds per one thousand (1,000) square feet of area. Fertilizer is not allowed within Bio-swale seed planting areas.
 - The application rate for Seed Lawn areas shall be two hundred-fifty pounds of seed per acre.
 - The application rate for Erosion Control Seed shall be two hundred-fifty pounds of seed per acre.
 - The application rate for Bio-Swale Seed shall be two hundred-fifty pounds of seed per acre.
- D. Seed Area Establishment
 - The Contractor shall be responsible for the watering, weeding, reseeding, mowing (Seed Lawn only), fertilizing and other necessary operations of seed areas until Final Acceptance of the project.
 - Seed beds must show vigorous growth with a FULL stand of grass and be uniform in appearance, free of weeds and/or other undesirable plant species as approved by the Landscape Architect. A FULL stand of grass is defined as a uniform grass cover with no bare spots over three (3) inches square.
 - To encourage deep rooting, each watering shall be thorough enough to provide soil moisture a minimum of six (6) inches below soil surface. Permit soil to dry sufficiently between watering, but not so dry as to damage the planting.
 - Check for barren areas [maximum three (3) inches square] in seed bed approximately twenty-one (21) days after seeding and overseed as originally specified at the time or at such time as weather and season permit for seed germination or as approved by the Landscape Architect.

3.07 PROTECTION

- A. All planting materials shall be properly protected against harm from normal weather conditions and the public by the Contractor until Final Acceptance. Maintenance of all the planted areas until Final Acceptance, shall include, but not be limited to, watering, mowing, weeding, and pruning as well as replacement of any plants that appear to be in distress. Tree stakes shall be kept secure at all times. Although planting shall occur in spring or fall of year when weather conditions are favorable, special planting techniques, defoliating, wilt proofing or spray misting may be required should unseasonable planting conditions occur. No work shall be performed in, over or adjacent to planting areas without approved protection and safeguards.
- B. Install protection for emergent plantings, shrubs, and trees as required at time of initial planting and additionally as needed to protect all plantings from damage by animals. Methods to control herbivory, such as tree tubes, are at the discretion of the contractor. Contractor is responsible for plant replacement if mortality results from a failed method.

3.08 CLEAN-UP

- A. Areas to be kept clean during progress of work and until completion. Water, dirt and rubbish to be kept off of all paved areas. Remove surplus materials and rubbish from planting beds, rake beds neatly to an even, fine grade around all plants and wash clean all paved areas. Leave project in first quality condition.

3.09 FINAL ACCEPTANCE

- A. Final acceptance of all landscaping work described in this Specification section, with the exclusion of possible replacements of plant materials under the Guarantee, shall be made by the Landscape Architect and/or approved representative of the Owner to determine one hundred (100) percent completion of the Contract work. This review shall be made upon written request to the Landscape Architect no less than forty-eight (48) hours prior to the anticipated date of inspection.

\$\$\$DATE\$\$\$
\$\$\$TIME\$\$\$
\$\$\$SCALE\$\$\$
\$\$\$PENTBL\$\$\$

NO.	W/O	COMPUTER	REVISION	ONLY	BY	DATE	APPROVED
C=CONTRACT CONSTR., FA=FORCE ACCOUNT CONSTR., R=RECORD FILE NAME: \$FILES\$							
Design	J. HOWARD	UNITED STATES DEPARTMENT OF ENERGY BONNEVILLE POWER ADMINISTRATION HEADQUARTERS, PORTLAND, OREGON NORTHEAST OREGON HATCHERY PROGRAM LOSTINE RIVER HATCHERY HATCHERY LANDSCAPE SPECIFICATIONS					
Drawn	R. LAMBERT						
Chkd	J. VONG/ F. BECK						
Sub							
Rec							
Rec		SERIAL	SOURCE	SHEET NO.	SHEET	REVISION	
Appr				L5	OF		
Date	4/10/06						

REGISTERED
248
Colie R. Hough-Beck
OREGON
LANDSCAPE ARCHITECT

Engineer Seal

HDR | FISHPRO

HOUGH BECK & BAIRD INC.
 LANDSCAPE ARCHITECTURE PLANNING
 & URBAN DESIGN
 215 WESTLAKE AVENUE NORTH
 SEATTLE, WASHINGTON 98109
 (206) 682-3051